



# Atharv Aaradhyam

—— A key to Lifestyle ——

**REDEVELOPMENT OF CHANDRASHEKHAR CHS**



## Atharv Aaradhyam

Welcome to Atharv Aaradhyam, a breathtaking development that harmoniously combines the beauty of nature with the convenience of contemporary living. Set across a sprawling 1.5 acres of gated community, this project features 5 stunning buildings designed to offer residents an unmatched experience of peace, luxury, and serenity.





Atharv  
Rosewood  
2014



Atharv  
Shagun  
2016

Atharv  
Palace  
2018



Atharv  
Pride  
2019



Atharv  
Saraswati  
2020

Atharv  
Murli  
2021



Atharv  
Navasamaj  
2021



Atharv  
Heights  
2022



Atharv  
Laxmi  
2022



Atharv  
Casa  
2023



Atharv  
Abrol  
2024







Excellence In Luxury Homes  
**BY TIMES REDEVELOPMENT  
AWARDS**  
2024



Timely Delivery Excellence Award  
**BY LOKMAT REAL ESTATE  
AWARDS**  
2024



People's Choice Award  
**BY NAREDCO**  
2024



People's Choice Award  
**BY NAREDCO**  
2023



Top Emerging Developer  
Mumbai Suburban  
**BY TIMES OF INDIA**  
2023



Best Construction Quality  
**BY REALTY QUARTERS**  
2023



Customer Choice Award  
**BY NAREDCO**  
2022



**15+**  
**LANDMARK PROJECTS**

**11 YRS**  
**OF BUILDING TRUST**

**1000+**  
**HAPPY FAMILIES**

**100+**  
**IN-HOUSE STAFF**







5 TOWERS  
12 FLOORS

• 70,000 SQ FT OF OPEN SPACE •

**50+  
Amenities**

**Spacious  
Balcony**

**Certified  
Green  
Building**

**Landscaped  
Gardens**

**Golf Cart  
Concierge**

**5000 SQ. FT.  
Exclusive Clubhouse**

**E- Charging  
Station**

**4000 SQ. FT.  
of Double Height  
Luxurious Lobbies**

**Gated  
Community**

**Prime  
Location**



# Upper Vile Parle



A Location that perfectly  
captures luxury and peace.



Ground Layout







# 50+ AMENITIES

|   |  |   |  |
|---|--|---|--|
| <br>GOLF CART<br>CONCIERGE                     | <br>GRAND<br>ENTRANCE               | <br>LANDSCAPED<br>GARDENS  | <br>DOUBLE HEIGHT<br>ENTRANCE LOBBY |
| <br>VISITORS<br>PARKING                        | <br>KIDS<br>PLAY AREA               | <br>GAZEBO                 | <br>SENIOR<br>CITIZEN AREA          |
| <br>INTERCONNECTED<br>TERRACE WALKING<br>TRACK | <br>TERRACE<br>RECREATIONAL<br>AREA | <br>SPACIOUS<br>BALCONY    | <br>SOLAR<br>ENERGY                 |
| <br>SPLASH<br>POOL                             | <br>FITNESS<br>CENTER               | <br>YOGA<br>ROOM           | <br>MEDITATION<br>AREA              |
| <br>MUSIC<br>ROOM                              | <br>INDOOR<br>GAME ROOM             | <br>LIBRARY                | <br>WORK FROM<br>HOME STATION       |
| <br>CAFETERIA                                | <br>BUSINESS<br>CONFERENCE        | <br>PET<br>FRIENDLY AREA | <br>MULTIPURPOSE<br>ROOM          |

& MANY MORE...





EXPLORE THE COMMUNITY WITH  
**GOLF CART CONCIERGE**





AN AWE-INSPIRING  
**GRAND ENTRANCE**





CREATING A

LASTING IMPRESSION



A DRIVEWAY TO

MODERN LIVING





A SERENE  
OUTDOOR HEAVEN

◆ 1 ACRE OF LANDSCAPED AREA ◆





THE PERFECT HOME FOR  
YOUR GROWING FAMILY





◆ 4,000 SQ FT OF LUXURIOUS LOBBIES ◆



STEP INTO OUR  
MAJESTIC LOBBY





STEP INTO  
THE NATURE

18,000 SQ. FT. OF INTERCONNECTED  
LANDSCAPED TERRACE





GAZEBO HAVEN

YOUR ROOFTOP ESCAPE





A

GARDEN IN THE SKY



## PRE - CERTIFIED GREEN BUILDING



Solid Waste  
Management  
System



Rain Water  
Harvesting.



Solar  
Electrification



Breathe Fresh!  
Use Of Low  
VOC Material



Electric Vehicle  
Charging Facility





REFRESH & REJUVENATE

## THE SPLASH POOL





Excuses  
Dont Burn  
*"Calories"*



EXPERIENCE A NEW  
LEVEL OF FITNESS





FIND INNER

PEACE & BALANCE



ECHOES OF CREATIVITY

MUSIC ROOM





A WORLD OF  
SMILES FOR KIDS



WORK FROM  
HOME STATION

A HOME FOR  
BOOK LOVERS





LUXURIOUS  
LIVING ROOM



VAASTU BY  
ISHAN VAASTU





16.786 pt



A MODERN  
KITCHEN SPACE



YOUR STYLISH  
BATHROOM RETREAT





SWEET DREAMS  
GUARANTEED







VIEW TO REMEMBER



# TOWER I FLOOR PLAN

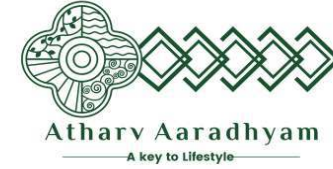

| FLAT NO. | CONFIGURATION | FLAT AREA  | BALCONY AREA | TOTAL AREA  |
|----------|---------------|------------|--------------|-------------|
| 1.       | 1 BHK         | 477 SQ.FT. | 17 SQ.FT.    | 494 SQ.FT.  |
| 2.       | 2 BHK         | 705 SQ.FT. | —            | 705 SQ.FT.  |
| 3.       | 3 BHK         | 973 SQ.FT. | 67 SQ.FT.    | 1040 SQ.FT. |
| 4.       | 3 BHK         | 855 SQ.FT. | 68 SQ.FT.    | 923 SQ.FT.  |



**KEY PLAN**

NOTE: Subject to M.C.G.M. C.F.O. E.E.T.C. and structural approvals.



**MAHARERA NO.P51800052443**

**Disclaimer-** The plans, designs, dimensions and elevations are as per current sanctioned plans and approvals, specifications, amenities and facilities will be set out in the agreements for sale and ancillary documentation and the images are artistic impressions and purely for representational purposes. The same may be subject to changes/revisions/alterations in terms of RCC design, column placements or architectural design, orders, approvals, directions and /or regulations of the concerned/relevant authorities, and/or for compliance with laws/regulations in force from time to time. In view of the above, and in line with our customer policies, we may change/alter the above in consonance with approvals, orders, directions, applicable laws, regulations, etc. Minor variations (+/-3%) in actual carpet area may occur on account of column position.



# TOWER I FLOOR PLAN

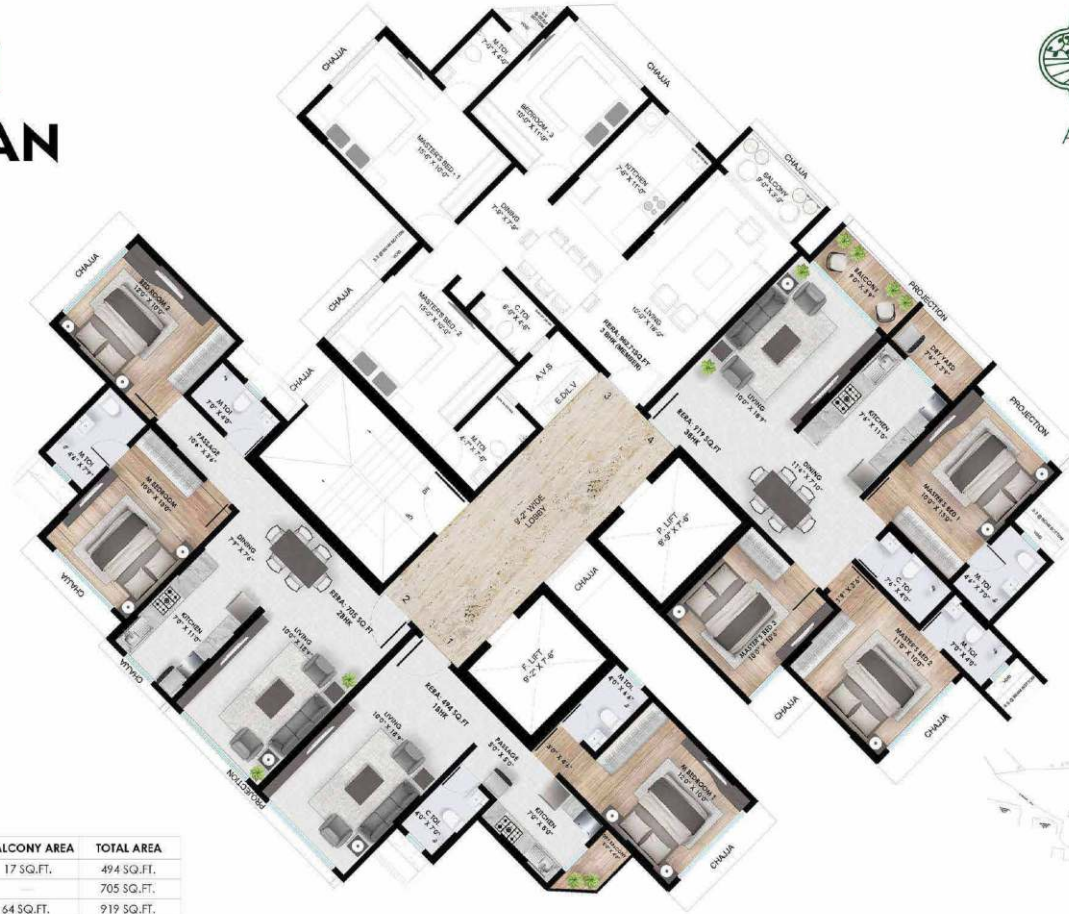
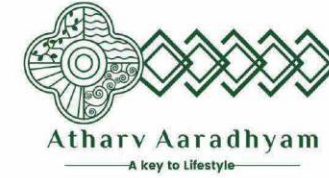

| FLAT NO. | CONFIGURATION | FLAT AREA  | BALCONY AREA | TOTAL AREA |
|----------|---------------|------------|--------------|------------|
| 1.       | 1 BHK         | 477 SQ.FT. | 17 SQ.FT.    | 494 SQ.FT. |
| 2.       | 2 BHK         | 705 SQ.FT. | —            | 705 SQ.FT. |
| 4.       | 3 BHK         | 855 SQ.FT. | 64 SQ.FT.    | 919 SQ.FT. |



**KEY PLAN**

NOTE: Subject to M.C.G.M, C.F.O, E.E.T.C. and structural approvals.



**MAHARERA NO.P51800052443**

**Disclaimer-** The plans, designs, dimensions and elevations are as per current sanctioned plans and approvals, specifications, amenities and facilities will be set out in the agreements for sale and ancillary documentation and the images are artistic impressions and purely for representational purposes. The same may be subject to changes/revisions/alterations in terms of RCC design, column placements or architectural design, orders, approvals, directions and /or regulations of the concerned/relevant authorities, and/or for compliance with laws/regulations in force from time to time. In view of the above, and in line with our customer policies, we may change/alter the above in consonance with approvals, orders, directions, applicable laws, regulations, etc. Minor variations (+/-3%) in actual carpet area may occur on account of column position.



# TOWER I FLOOR PLAN (JODI OPTION)

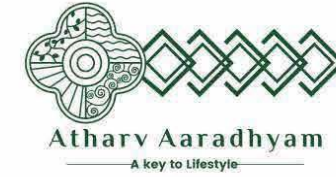

| FLAT NO. | CONFIGURATION | FLAT AREA   | BALCONY AREA | TOTAL AREA  |
|----------|---------------|-------------|--------------|-------------|
| 1.       | 3 BHK         | 1189 SQ.FT. | 17 SQ.FT.    | 1206 SQ.FT. |
| 2.       | 5 BHK         | 1638 SQ.FT. | 135 SQ.FT.   | 1973 SQ.FT. |

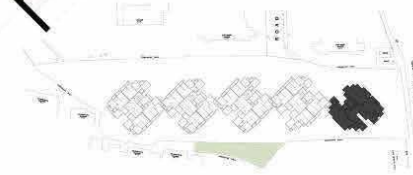

## KEY PLAN

NOTE: Subject to M.C.G.M. C.F.O. E.E.T.C. and structural approvals.



**MAHARERA NO.P51800052443**

**Disclaimer-** The plans, designs, dimensions and elevations are as per current sanctioned plans and approvals, specifications, amenities and facilities will be set out in the agreements for sale and ancillary documentation and the images are artistic impressions and purely for representational purposes. The same may be subject to changes/revisions/alterations in terms of RCC design, column placements or architectural design, orders, approvals, directions and /or regulations of the concerned/relevant authorities, and/or for compliance with laws/regulations in force from time to time. In view of the above, and in line with our customer policies, we may change/alter the above in consonance with approvals, orders, directions, applicable laws, regulations, etc. Minor variations (+/-3%) in actual carpet area may occur on account of column position.



# TOWER II FLOOR PLAN

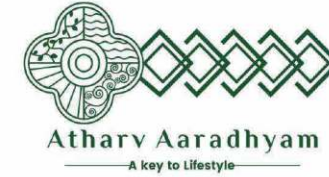

| FLAT NO. | CONFIGURATION | FLAT AREA  | BALCONY AREA | TOTAL AREA |
|----------|---------------|------------|--------------|------------|
| 1.       | 3 BHK         | 847 SQ.FT. | 62 SQ.FT.    | 909 SQ.FT. |
| 2.       | 2 BHK         | 678 SQ.FT. | 67 SQ.FT.    | 745 SQ.FT. |
| 4.       | 2.5 BHK       | 815 SQ.FT. | 64 SQ.FT.    | 879 SQ.FT. |



**KEY PLAN**

NOTE: Subject to M.C.G.M, C.F.O, E.E.T.C. and structural approvals.



**MAHARERA NO.P51800052443**

**Disclaimer-** The plans, designs, dimensions and elevations are as per current sanctioned plans and approvals, specifications, amenities and facilities will be set out in the agreements for sale and ancillary documentation and the images are artistic impressions and purely for representational purposes. The same may be subject to changes/revisions/alterations in terms of RCC design, column placements or architectural design, orders, approvals, directions and /or regulations of the concerned/relevant authorities, and/or for compliance with laws/regulations in force from time to time. In view of the above, and in line with our customer policies, we may change/alter the above in consonance with approvals, orders, directions, applicable laws, regulations, etc. Minor variations (+/-3%) in actual carpet area may occur on account of column position.



# TOWER II FLOOR PLAN (JODI OPTION)

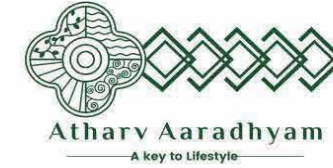

| FLAT NO. | CONFIGURATION | FLAT AREA   | BALCONY AREA | TOTAL AREA  |
|----------|---------------|-------------|--------------|-------------|
| 1.       | 4 BHK         | 1535 SQ.FT. | 128 SQ.FT.   | 1663 SQ.FT. |
| 2.       | 2.5 BHK       | 815 SQ.FT.  | 64 SQ.FT.    | 879 SQ.FT.  |



## KEY PLAN

NOTE: Subject to M.C.G.M. C.F.O. E.E.T.C. and structural approvals.



**MAHARERA NO.P51800052443**

**Disclaimer:** The plans, designs, dimensions and elevations are as per current sanctioned plans and approvals, specifications, amenities and facilities will be set out in the agreements for sale and ancillary documentation and the images are artistic impressions and purely for representational purposes. The same may be subject to changes/revisions/alterations in terms of RCC design, column placements or architectural design, orders, approvals, directions and /or regulations of the concerned/relevant authorities, and/or for compliance with laws/regulations in force from time to time. In view of the above, and in line with our customer policies, we may change/alter the above in consonance with approvals, orders, directions, applicable laws, regulations, etc. Minor variations (+/-3%) in actual carpet area may occur on account of column position.



# TOWER II FLOOR PLAN

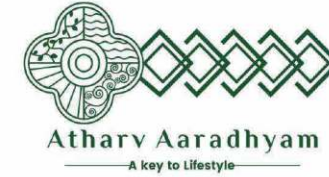

| FLAT NO. | CONFIGURATION | FLAT AREA  | BALCONY AREA | TOTAL AREA |
|----------|---------------|------------|--------------|------------|
| 1.       | 3 BHK         | 847 SQ.FT. | 58 SQ.FT.    | 905 SQ.FT. |
| 2.       | 2 BHK         | 678 SQ.FT. | 63 SQ.FT.    | 741 SQ.FT. |
| 4.       | 2.5 BHK       | 815 SQ.FT. | 64 SQ.FT.    | 879 SQ.FT. |



**KEY PLAN**

NOTE: Subject to M.C.G.M, C.F.O, E.E.T.C. and structural approvals.



**MAHARERA NO.P51800052443**

**Disclaimer-** The plans, designs, dimensions and elevations are as per current sanctioned plans and approvals, specifications, amenities and facilities will be set out in the agreements for sale and ancillary documentation and the images are artistic impressions and purely for representational purposes. The same may be subject to changes/revisions/alterations in terms of RCC design, column placements or architectural design, orders, approvals, directions and /or regulations of the concerned/relevant authorities, and/or for compliance with laws/regulations in force from time to time. In view of the above, and in line with our customer policies, we may change/alter the above in consonance with approvals, orders, directions, applicable laws, regulations, etc. Minor variations (+/-3%) in actual carpet area may occur on account of column position.



# TOWER III-IV-V FLOOR PLAN

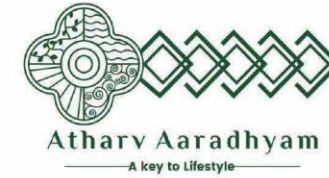

| FLAT NO. | CONFIGURATION | FLAT AREA  | BALCONY AREA | TOTAL AREA |
|----------|---------------|------------|--------------|------------|
| 1.       | 3 BHK         | 847 SQ.FT. | 58 SQ.FT.    | 905 SQ.FT. |
| 2.       | 2 BHK         | 707 SQ.FT. | 63 SQ.FT.    | 770 SQ.FT. |
| 4.       | 3 BHK         | 847 SQ.FT. | 58 SQ.FT.    | 905 SQ.FT. |



**KEY PLAN**

NOTE: Subject to M.C.G.M, C.F.O, E.E.T.C. and structural approvals.



**MAHARERA NO.P51800052443**

**Disclaimer-** The plans, designs, dimensions and elevations are as per current sanctioned plans and approvals, specifications, amenities and facilities will be set out in the agreements for sale and ancillary documentation and the images are artistic impressions and purely for representational purposes. The same may be subject to changes/revisions/alterations in terms of RCC design, column placements or architectural design, orders, approvals, directions and /or regulations of the concerned/relevant authorities, and/or for compliance with laws/regulations in force from time to time. In view of the above, and in line with our customer policies, we may change/alter the above in consonance with approvals, orders, directions, applicable laws, regulations, etc. Minor variations (+/-3%) in actual carpet area may occur on account of column position.



# TOWER III-IV-V FLOOR PLAN (JODI OPTION)

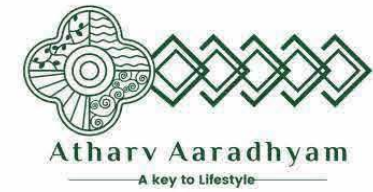

| FLAT NO. | CONFIGURATION | FLAT AREA   | BALCONY AREA | TOTAL AREA  |
|----------|---------------|-------------|--------------|-------------|
| 1.       | 4 BHK         | 1564 SQ.FT. | 129 SQ.FT.   | 1693 SQ.FT. |
| 2.       | 5 BHK         | 1780 SQ.FT. | 167 SQ.FT.   | 1947 SQ.FT. |

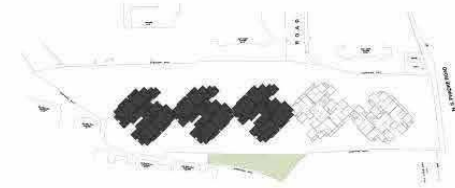

**KEY PLAN**

NOTE: Subject to M.C.G.M. C.F.O. E.E.T.C. and structural approvals.



**MAHARERA NO.P51800052443**

**Disclaimer-** The plans, designs, dimensions and elevations are as per current sanctioned plans and approvals, specifications, amenities and facilities will be set out in the agreements for sale and ancillary documentation and the images are artistic impressions and purely for representational purposes. The same may be subject to changes/revisions/alterations in terms of RCC design, column placements or architectural design, orders, approvals, directions and /or regulations of the concerned/relevant authorities, and/or for compliance with laws/regulations in force from time to time. In view of the above, and in line with our customer policies, we may change/alter the above in consonance with approvals, orders, directions, applicable laws, regulations, etc. Minor variations (+/-3%) in actual carpet area may occur on account of column position.



# TOWER III-IV-V FLOOR PLAN

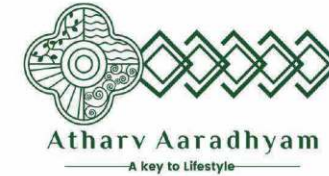

| FLAT NO. | CONFIGURATION | FLAT AREA  | BALCONY AREA | TOTAL AREA  |
|----------|---------------|------------|--------------|-------------|
| 1.       | 3 BHK         | 847 SQ.FT. | 62 SQ.FT.    | 909 SQ.FT.  |
| 2.       | 2 BHK         | 707 SQ.FT. | 67 SQ.FT.    | 774 SQ.FT.  |
| 3.       | 3 BHK         | 926 SQ.FT. | 109 SQ.FT.   | 1035 SQ.FT. |
| 4.       | 3 BHK         | 847 SQ.FT. | 58 SQ.FT.    | 905 SQ.FT.  |



**KEY PLAN**

NOTE: Subject to M.C.G.M, C.F.O, E.E.T.C. and structural approvals.



**MAHARERA NO.P51800052443**

**Disclaimer-** The plans, designs, dimensions and elevations are as per current sanctioned plans and approvals, specifications, amenities and facilities will be set out in the agreements for sale and ancillary documentation and the images are artistic impressions and purely for representational purposes. The same may be subject to changes/revisions/alterations in terms of RCC design, column placements or architectural design, orders, approvals, directions and /or regulations of the concerned/relevant authorities, and/or for compliance with laws/regulations in force from time to time. In view of the above, and in line with our customer policies, we may change/alter the above in consonance with approvals, orders, directions, applicable laws, regulations, etc. Minor variations (+/-3%) in actual carpet area may occur on account of column position.







## RETAIL

D Mart  
Nature's Basket  
Star Bazar

## PARK

Sardar Vallabhbhai Patel Park  
Lallubhai Park

## SHOPPING

Shoppers Stop

## COMMERCIAL OFFICES

Huhtown Solaris  
Kaledonia  
Gokul Arcade  
Matharu Arcade

## ELECTRONICS

Vijay Sales  
Zee Electronics

## HOTEL

Regency Hotel  
Courtyard By Marriott  
The Leela Mumbai  
ITC Maratha  
The Orchid Hotel

## SCHOOL AND COLLEGES

Paranjape Vidyalaya  
Sathaye College  
Parle Tilak Vidyalaya  
KLAY Prep Schools and DayCare  
Sheth M. A. School  
Bombay Cambridge International School  
MVLU College  
Shri Chinai College

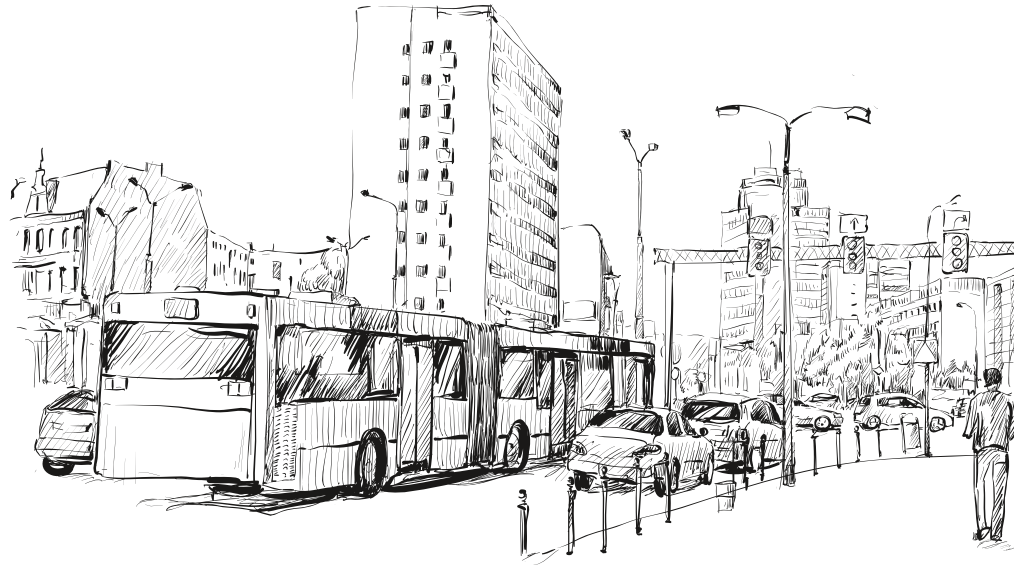

## DOMESTIC & INTERNATIONAL AIRPORT

Chhatrapati Shivaji Maharaj International Airport  
Terminal 1 & Terminal 2

## Railway STATION

Vile Parle Station  
Andheri Station

## METRO STATION

Andheri Metro Station  
Gundavali Metro Station

## HIGHWAY

Western Express Highway

## BANQUETS

Symphony Banquets  
Vishal Hall - Banquet

## GAS STATION

Bharat Petroleum Corporation Ltd

## CINEMA & THEATRE

SunCity Mukta A2 Cinemas  
Carnival Theatre  
Dinanath Natyagriha  
Bahar Cinema

## HOSPITAL

Sanjeevani hospital  
Criticare Asia  
KLS hospital  
Jeevan Vikas Hospital

## CLUBS

Lions Club of Andheri  
Prabodhankar Thackeray Krida Sankul

## TEMPLE

Ganesh Mandir  
Mahalaxmi Temple  
Jain Deraser

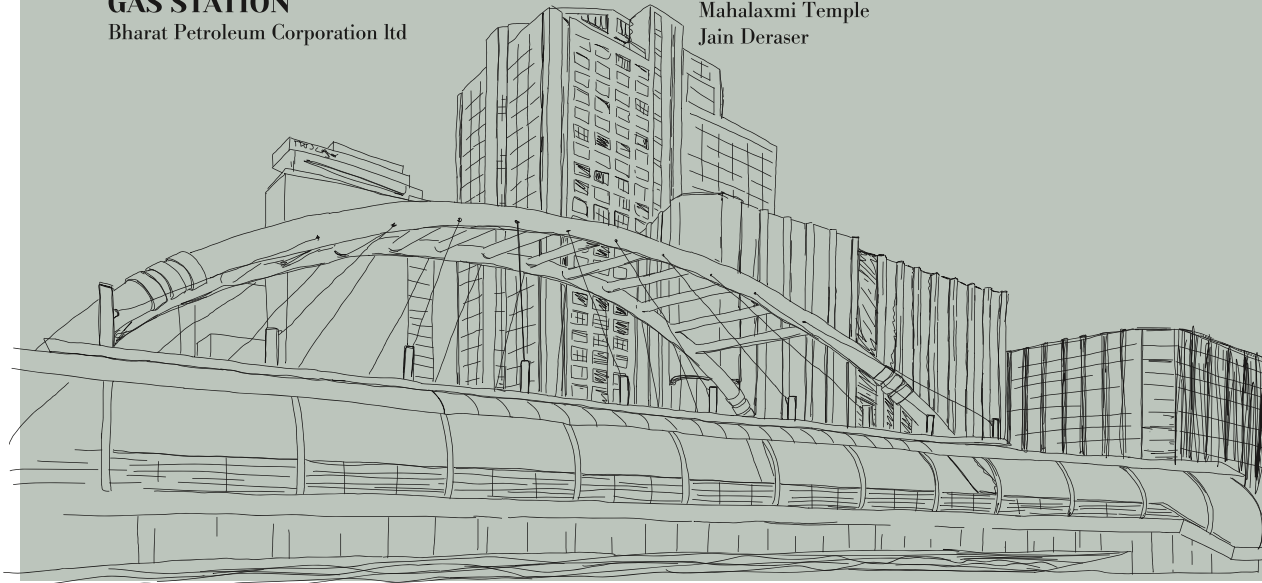





**Corporate Office.: Atharv House, Nariman Road, Vile Parle East, Mumbai - 400057.**

**Site Office.: Atharv Aaradhyam, Chandrashekhhar CHS, Sahar Road, Andheri East, Mumbai - 400069.**

Mob.: +91 77388 66111 | [www.atharvlifestyle.com](http://www.atharvlifestyle.com) | [sales@atharvlifestyle.com](mailto:sales@atharvlifestyle.com)



**MAHARERA NO.: P51800052443**



**Disclaimer.:** Unless otherwise stated, all the images, visuals, materials and information contained herein are purely creative/artistic concepts and may not be actual representations of the product and/or any amenities. None of the above may be construed to form any basis of, or serve as an inducement/solicitation or invitation for payment of any advance and/or deposit, to be made by a prospective customer, under relevant provisions of law or otherwise. The plans, designs, dimensions and elevations are as per current sanctioned plans and approvals, specifications, amenities and facilities will be set out in the agreements for sale and ancillary documentation and the images are artistic impressions and purely for representational purposes. The same may be subject to changes/revisions/alterations in terms of approvals, orders, directions and/or regulations of the concerned/relevant authorities, and/or for compliance with laws/regulations in force from time to time. In view of the above, and in line with our customer policies, we may change/alter the above in consonance with approvals, orders, directions, applicable laws, regulations, etc. The furniture, furnishings, fixtures, fittings, electronic goods, accessories and any other item displayed in floor plan are only indicative in nature. The company/firm/promoter/developer is not liable or required to provide the furniture, furnishings, fixtures, fittings, electronic goods, accessories and any other item as displayed in floor plan. Minor variations (+/-3%) in actual carpet area may occur on account of column position